

No.	Part No.	Description
	2152-100-99	Replacement Part Kit With Polyurethane Sleeve
1.	2152-000-01	Knob
2.	2152-000-17	Breather Vent
3.	2152-000-12	Spring Retainer
4.*	2152-000-18	O-Ring
5.	7027-503-02	Washer
6.	7010-507-07	Hex Bolt, 3/8" UNC x 1-1/4" Lg.
7.	2152-000-02	Cap Plate
8.*	2152-000-16	Cap Gasket
10.	2152-000-25	Vibration Disc
11.	2152-000-03	Spring
12.	2149-000-08	Nut
13.*	2149-000-04	Piston Seal
14.	2152-000-05	Piston
15.*	2152-000-07	Tungsten Carbide Plunger
16.	2152-000-09	Cylinder
17.*	2152-000-06	Plunger Seal, 1-req'd (Purple Urethane)
18.*	2152-000-06	Plunger Seal, 2-req'd (Purple Urethane)
19.	2152-000-14	Body
20.*	2152-100-13	Polyurethane Sleeve
21.	2152-000-15	Base, 1 1/4" NPT
22.	7010-507-95	Hex Bolt, 3/8" UNC x 4 3/4" Lg.
23.	3014-506	Plug
24.	2149-000-16	Sleeve Pin

\* Included In Replacement Part Kit For Polyurethane Sleeve

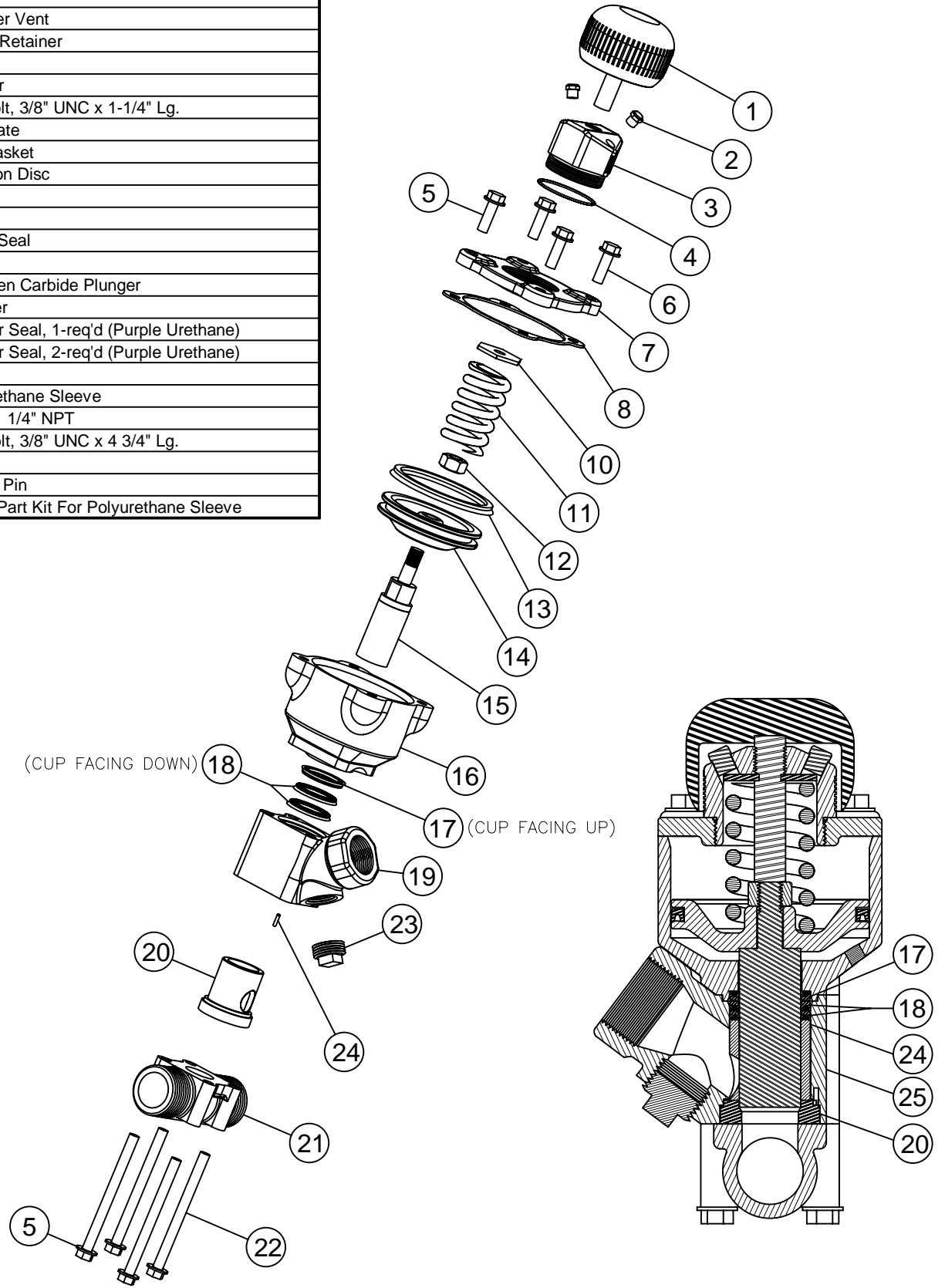

REV	DESCRIPTION	DATE	BY
B	ITEM 17 WAS 2149-500-06	11/15/07	JH
A	DELETED BUMP RING, REFER TO ECR S-0040	12/22/05	JH

SCHMIDT

SCALE: N.T.S.	APPROVED BY:	DRAWN BY: JH
DATE: 9/22/03		REVISED
1 1/4" THOMPSON VALVE II WITH POLYURETHANE SLEEVE		
PART NUMBER: 2152-107	DRAWING NUMBER: 2152-107	